

SHOWPRO

esunstrip

Reproduces the look and feel
of the classic halogen sunstrip effect

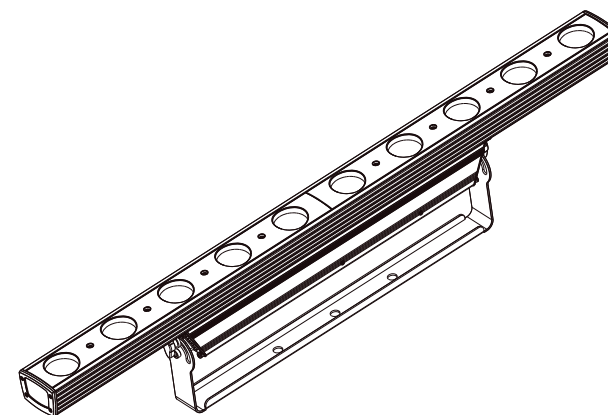

SHOWPRO

www.showtech.com.au

USER MANUAL

EN

4.3 TROUBLESHOOTING

Problems	Possible causes	Checks and remedies
Fixture does not light up	<ul style="list-style-type: none"> No mains supply Dimmer fader set to 0 All color faders set to 0 Faulty LED Faulty LED board 	<ul style="list-style-type: none"> Check the power supply voltage Increase the value of the dimmer channels Increase the value of the color channels Replace the LED board Replace the LED board
General low light intensity	<ul style="list-style-type: none"> Dirty lens assembly Misaligned lens assembly 	<ul style="list-style-type: none"> Clean the fixture regularly Install lens assembly properly
Fixture does not power up	<ul style="list-style-type: none"> No power Loose or damaged power cord Faulty internal power supply 	<ul style="list-style-type: none"> Check for power on power outlet Check power cord Replace internal power supply
Fixture does not respond to DMX	<ul style="list-style-type: none"> Wrong DMX addressing Damaged DMX cables Bouncing signals 	<ul style="list-style-type: none"> Check control panel and unit addressing Check DMX cables Install terminator as suggested



WARNING! Before carrying out any operations with the unit, carefully read this instruction manual and keep it with care for future reference. It contains important information about the installation, usage and maintenance of the unit.

**SAFETY****General instruction**

- The products referred to in this manual conform to the European Community Directives and are therefore marked with **CE**.
- The unit is supplied with hazardous network voltage (230V~). Leave servicing to skilled personnel only. Never make any modifications on the unit not described in this instruction manual, otherwise you will risk an electric shock.
- Connection must be made to a power supply system fitted with efficient earthing (Class I appliance according to standard EN 60598-1). It is, moreover, recommended to protect the supply lines of the units from indirect contact and/or shorting to earth by using appropriately sized residual current devices.
- The connection to the main network of electric distribution must be carried out by a qualified electrical installer. Check that the main frequency and voltage correspond to those for which the unit is designed as given on the electrical data label.
- This unit is not for home use, only professional applications.
- Never use the fixture under the following conditions:
 - in places subject to vibrations or bumps;
 - in places with an ambient temperature of over 45°C.
- Make certain that no inflammable liquids, water or metal objects enter the fixture.
- Do not dismantle or modify the fixture.
- All work must always be carried out by qualified technical personnel. Contact the nearest sales point for an inspection or contact the manufacturer directly.
- If the unit is to be put out of operation definitively, take it to a local recycling plant for a disposal which is not harmful to the environment.

**Warnings and installation precautions**

- If this device will be operated in any way different to the one described in this manual, it may suffer damage and the guarantee becomes void. Furthermore, any other operation may lead to dangers like short circuit, burns, electric shock, etc.
- Always inspect the mechanical and electrical parts of the unit before fitting to check they are not damaged. Do not operate the product if you see damage. If the part is damaged, it has to be replaced by a qualified technician.
- When hanging the product, always use a safety cable. When carrying out any work, always comply scrupulously with all the regulations (particularly regarding safety) currently in force in the country in which the fixture's being used.
- Before starting any maintenance work or cleaning the fixture, cut off power from the main supply.
- Install the fixture in a well ventilated place.
- Make sure that the device is not exposed to extreme heat, moisture or dust.
- Keep any inflammable material at a safe distance from the fixture.
- The lamp (LED) shall be changed if it has become damaged or thermally deformed.
- Never look directly at the light beam. Please note that fast changes in lighting, e. g. flashing light, may trigger epileptic seizures in photosensitive persons or persons with epilepsy.
- Never remove warning or informative labels from the unit.
- For replacement use fuses of same type and rating only.

- 1 - INTRODUCTION

ESUNSTRIP is a pixel mappable LED effect that reproduces the look and feel of the classic halogen sunstrip effect.

1.1 FEATURES

- 10 x 10W 2800K White LEDs deliver higher output than traditional 10 x 50W sunstrips
- Variety of dimming curves to accurately evoke the look and feel of this classic effect
- DMX control

1.2 SPECIFICATIONS

- Light Source: 10W 2800K White LED (Cree)
- Beam Angle: 11°
- Field Angle: 23°
- Output: 2710 LUX @ 5 meters
- Color Output: Warm White
- Pixel Matrix: 10 x 1
- Strobe: 0-30 Hz
- Dimming: 4 dimming curve modes
- Control: DMX
- DMX Channels: 5 / 10 / 15
- Display: OLED function menu with 4 touch button
- Mains: 100V-240V, 50/60Hz
- Consumption: 120W/230V
- Power Linking: Up to 12 units @ 120V ~ Up to 24 units @ 230V
- Power connections: Neutrik PowerCon In/Out
- Data connections: 3-pin and 5-pin XLR In/Out for DMX
- Housing: Plastic and steel
- Finish: Matte black
- IP rating: IP20
- Cooling: Passive
- Dimensions: 992 x 69 x 196 MM
- Weight: 4.83 KG

- 4 - MAINTENANCE**4.1 MAINTENANCE AND CLEANING THE UNIT**

- Make sure the area below the installation place is free from unwanted persons during setup.
- Switch off the unit, unplug the main cable and wait until the unit has cooled down.
- All screws used for installing the device and any of its parts should be tightly fastened and should not be corroded.
- Housings, fixations and installation spots (ceiling, trusses, suspensions) should be totally free from any deformation.
- When the lens is visibly damaged due to cracks or deep scratches, it must be replaced.
- The main cables must be in impeccable condition and should be replaced immediately even when a small problem is detected.
- In order to protect the device from overheating the cooling fans (if any), and ventilation openings should be cleaned monthly.

To ensure optimal operation and performance for a long time it is essential to periodically clean the parts subject to dust and grease deposits. The frequency with which the following operations are to be carried out depends on various factors, such as the amount of the effects and the quality of the working environment (air humidity, presence of dust, salinity, etc.). Use a soft cloth dampened with any detergent liquid for cleaning glass to remove the dirt from the reflectors, from the lenses and filters.

It is recommended that the projector undergoes an annual service by a qualified technician for special maintenance involving at least the following operations:

- General cleaning of internal parts..
- Restoring lubrication of all parts subject to friction, using lubricants specifically.
- General visual check of the internal components, cabling, mechanical parts, etc.
- Electrical, photometric and functional checks; eventual repairs.

Warning: we strongly recommend internal cleaning to be carried out by qualified personnel!

4.2 FUSE REPLACEMENT

1. Disconnect this product from the power outlet.
2. Using a screwdriver, unscrew the fuse holder cap from the housing.
3. Remove the blown fuse and replace with a good fuse of the same type and rating (T2A/250V).
4. Screw the fuse holder cap back in place and reconnect power.

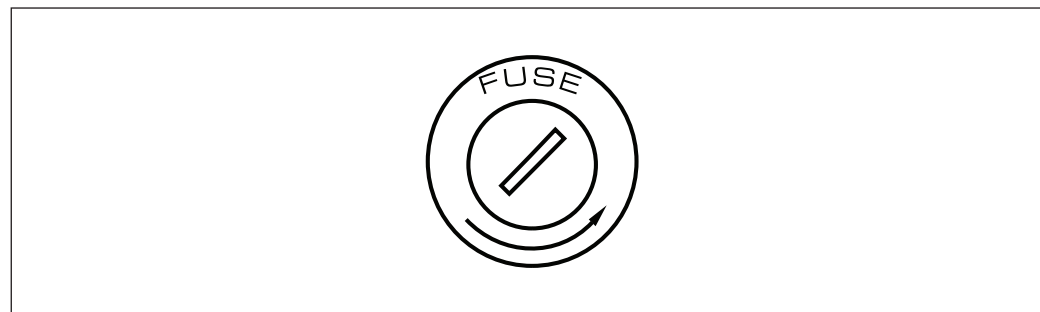

3.3 DMX CONTROL

15CH

Function	Value	Percent / Setting
White1	000-255	0~100%
White2	000-255	0~100%
White3	000-255	0~100%
White4	000-255	0~100%
White5	000-255	0~100%
White6	000-255	0~100%
White7	000-255	0~100%
White8	000-255	0~100%
White9	000-255	0~100%
White10	000-255	0~100%
Auto Programs	000-010	No Function
	011-038	Auto program 1
	039-066	Auto program 2
	067-094	Auto program 3
	095-122	Auto program 4
	123-150	Auto program 5
	151-178	Auto program 6
	179-206	Auto program 7
	207-234	Auto program 8
	235-255	Auto program 0
Auto speed	000-255	Auto programs speed slow to fast
Dimmer	000-255	0~100%
Strobe	000-010	NO Function
	011-255	Strobe slow to fast
Dimmer speed mode	000-051	Preset dimmer speed from display menu
	052-101	Dimmer speed mode off
	102-152	Dimmer speed mode1 (fast speed)
	153-203	Dimmer speed mode2 (middle speed)
	204-255	Dimmer speed mode3 (slow speed)

3.4 DMX ADDRESSING

Examples of various DMX starting addresses are shown below for 5-, 10- and 15-channel modes:

Number of DMX channels	Start address (example)	Next fixture starting address	Next fixture starting address	Next fixture starting address
5	001	006	011	016
10	016	026	036	046
15	033	048	063	078

1.3 DIMENSIONS

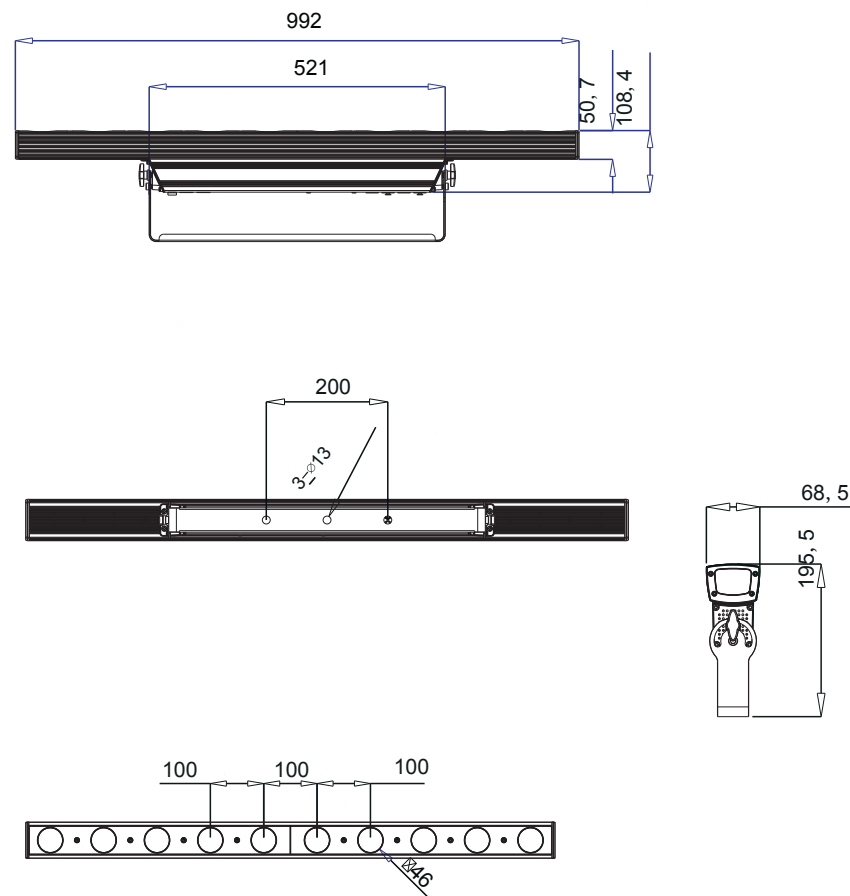

1.4 OVERVIEW

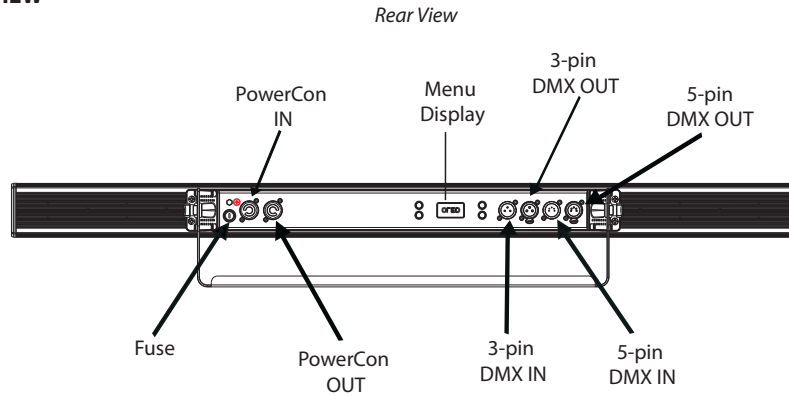

Front View

Numbers show below describe pixel position corresponding to DMX channel order

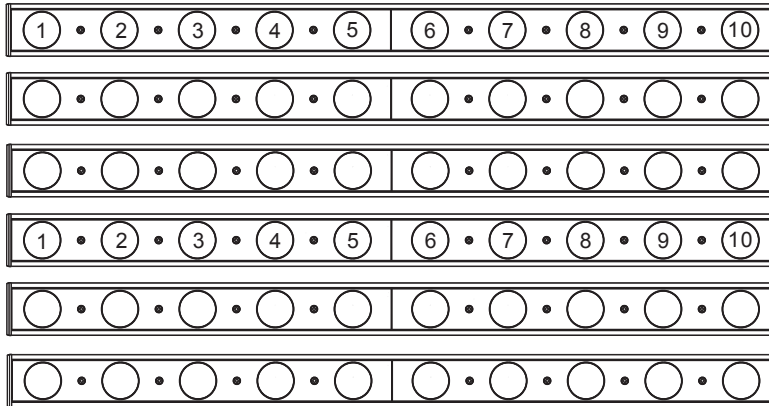

3.3 DMX CONTROL

5CH

Function	Value	Percent / Setting
Dimmer	000-255	0~100%
Strobe	000-010	NO Function
	011-255	Strobe slow to fast
Auto Programs	000-010	No Function
	011-038	A uto program 1
	039-066	A uto program 2
	067-094	A uto program 3
	095-122	A uto program 4
	123-150	A uto program 5
	151-178	A uto program 6
	179-206	A uto program 7
	207-234	A uto program 8
235-255	A uto program 0	
Auto speed	000-255	A uto programs speed slow to fast
Dimmer speed mode	000-051	Preset dimmer speed from display menu
	052-101	Dimmer speed mode off
	102-152	Dimmer speed mode1 (fast speed)
	153-203	Dimmer speed mode2 (middle speed)
	204-255	Dimmer speed mode3 (slow speed)

10CH

Function	Value	Percent / Setting
White1	000-255	0~100%
White2	000-255	0~100%
White3	000-255	0~100%
White4	000-255	0~100%
White5	000-255	0~100%
White6	000-255	0~100%
White7	000-255	0~100%
White8	000-255	0~100%
White9	000-255	0~100%
White10	000-255	0~100%

3.1 CONNECTION OF THE DMX LINE

DMX connection employs standard XLR connectors. Use shielded pair-twisted cables with 120Ω impedance and low capacity.

The following diagram shows the connection mode:

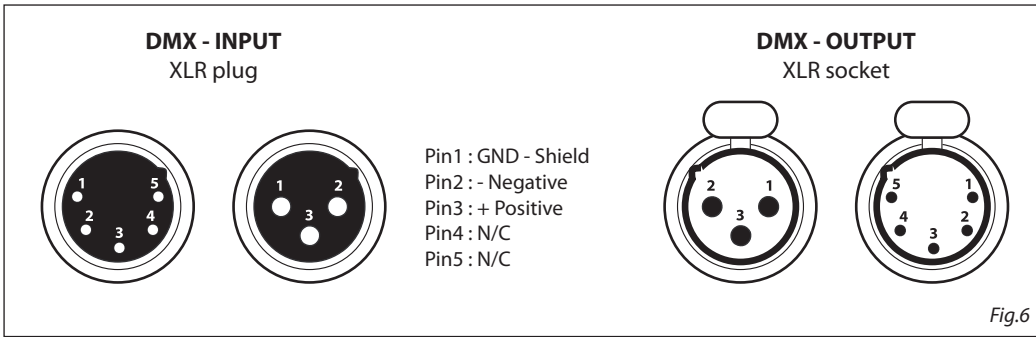

ATTENTION

The screened parts of the cable (sleeve) must never be connected to the system's earth, as this would cause faulty fixture and controller operation.

Over long runs can be necessary to insert a DMX level matching amplifier.

For those connections the use of balanced microphone cable is not recommended because it cannot transmit control DMX data reliably.

- Connect the controller DMX input to the DMX output of the first unit.
- Connect the DMX output to the DMX input of the following unit. Connect again the output to the input of the following unit until all the units are connected in chain.
- When the signal cable has to run longer distance is recommended to insert a DMX termination on the last unit.

3.2 CONSTRUCTION OF THE DMX TERMINATION

The termination avoids the risk of DMX 512 signals being reflected back along the cable when they reach the end of the line: under certain conditions and with certain cable lengths, this could cause them to cancel the original signals.

The termination is prepared by soldering a 120Ω 1/4 W resistor between pins 2 and 3 of the 5-pin male XLR connector, as shown in figure.

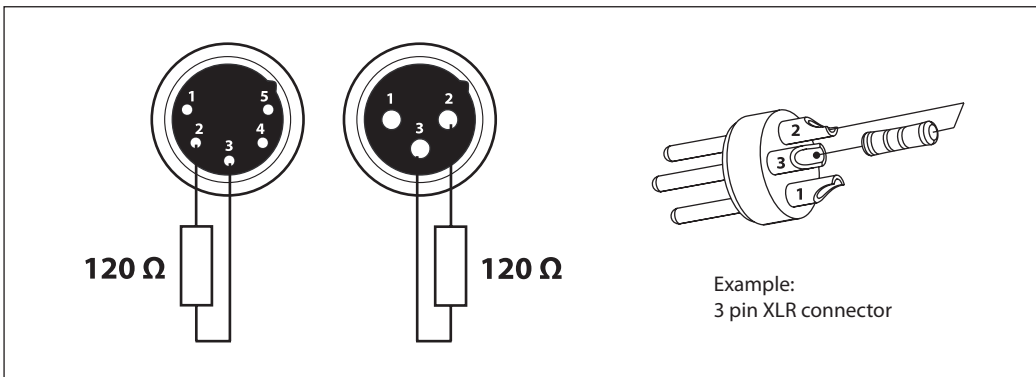

1.5 POWER AND DMX LINKING ILLUSTRATION

POWER LINKING

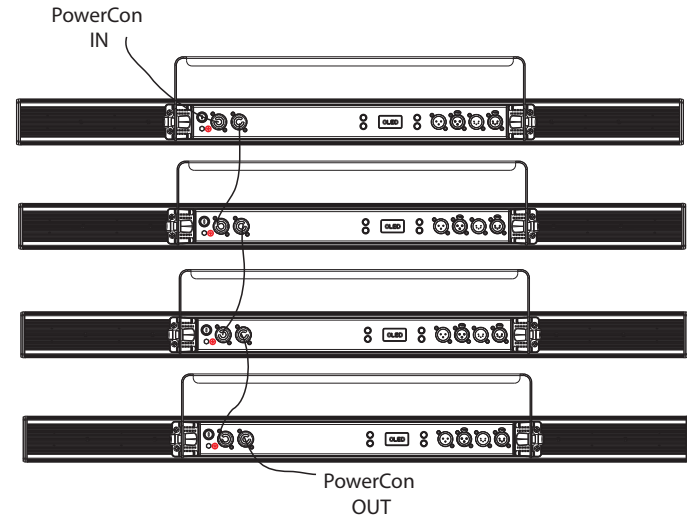

DMX LINKING

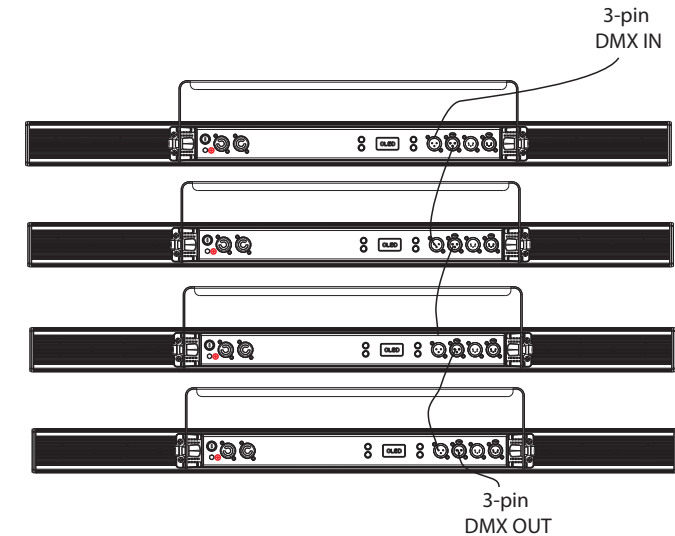

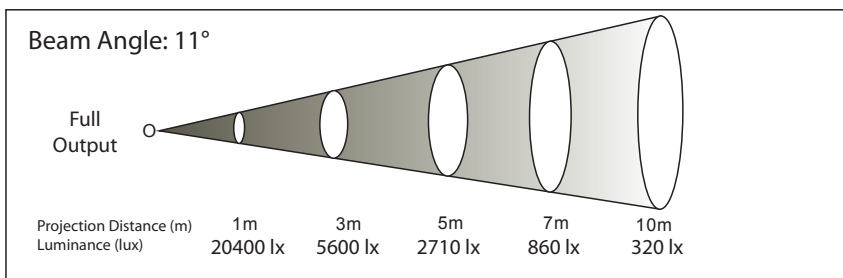
1.6 PHOTOMETRICS**- 2 - FUNCTIONS****2.1 CONTROL MENU OVERVIEW****CONTROL PANEL**

BUTTON	FUNCTION
Menu	Selects operating mode or exits submenus
Up	Scrolls up through option lists or selects higher value
Down	Scrolls down through option lists or selects lower value
Enter	Activates displayed menu option or selected value

2.2 FUNCTION MENU

MODE	OPTIONS / VALUES	DESCRIPTION
Auto Show	Auto Show	Auto Speed
	<Auto 0>	<100>
	<Auto 1>	<100>
	<Auto 2>	<100>
	<Auto 3>	<100>
	<Auto 4>	<100>
	<Auto 5>	<100>
	<Auto 6>	<100>
	<Auto 7>	<100>
	<Auto 8>	<100>
Static	Dimmer	0-255
	Strobe	0-255
Dimmer Mode	<Off>	
	<Dimmer 1>	
	<Dimmer 2>	
	<Dimmer 3>	
Back Light	<On>	
	<10S>	
	<20S>	
	<30S>	
Information	Auto Test	Auto Test...
	Fixture Hours	9999
	Version	V1.0
DMX Address	1-512	
DMX Channel	<5Ch>	
	<10Ch>	
	<15Ch>	
Master/Slave	<Master>	

Function notes:

- Auto Show:** Select Auto programs and speed
- Static:** Set the intensity of the light output and select strobe frequency
- Dimmer Mode:** Select dimming curves [Dimmer 1 (fast) ~ Dimmer 3 (slow)] or OFF
- Back Light:** Turns off display backlight after 10 seconds of inactivity
Turns off display backlight after 20 seconds of inactivity
Turns off display backlight after 30 seconds of inactivity
- Auto Test:** Turns on all LEDs in sequence for testing
- Master/Slave:** Toggle between MASTER and SLAVE modes